

This document must not be copied without our written permission, and the contents thereof must not be imparted to a third party nor be used for any unauthorized purpose. Contravention will be prosecuted.

Following standards apply for this drawing:
 SS-EN ISO 8015
 SS-EN ISO 4288 [AD]-TS0062
 see entire drawing for additional standards

ISO 2768mk
 [AD]-TS0061
 (valid if stated on drawing)

| | |
|-----------------|-----------|
| Basic size (mm) | Dev. (mm) |
| -6 | +0.1 |
| (6)-30 | +0.2 |
| (30)-120 | +0.3 |
| (120)-400 | +0.5 |
| (400)-1000 | +0.8 |

| | |
|--------------------------|-----------|
| Ext. radius chamfer (mm) | Dev. (mm) |
| -0.5 | +0.1 |
| (0.5)-3 | +0.2 |
| (3)-6 | +0.5 |
| (6) | +1 |

| | |
|---------------------------|----------|
| Angular short length (mm) | Dev. (°) |
| -1 | +3° |
| (1)-10 | +1° |
| (10)-50 | +0°30' |
| (50)-120 | +0°20' |
| (120)-400 | +0°10' |
| (400)- | +0°5' |

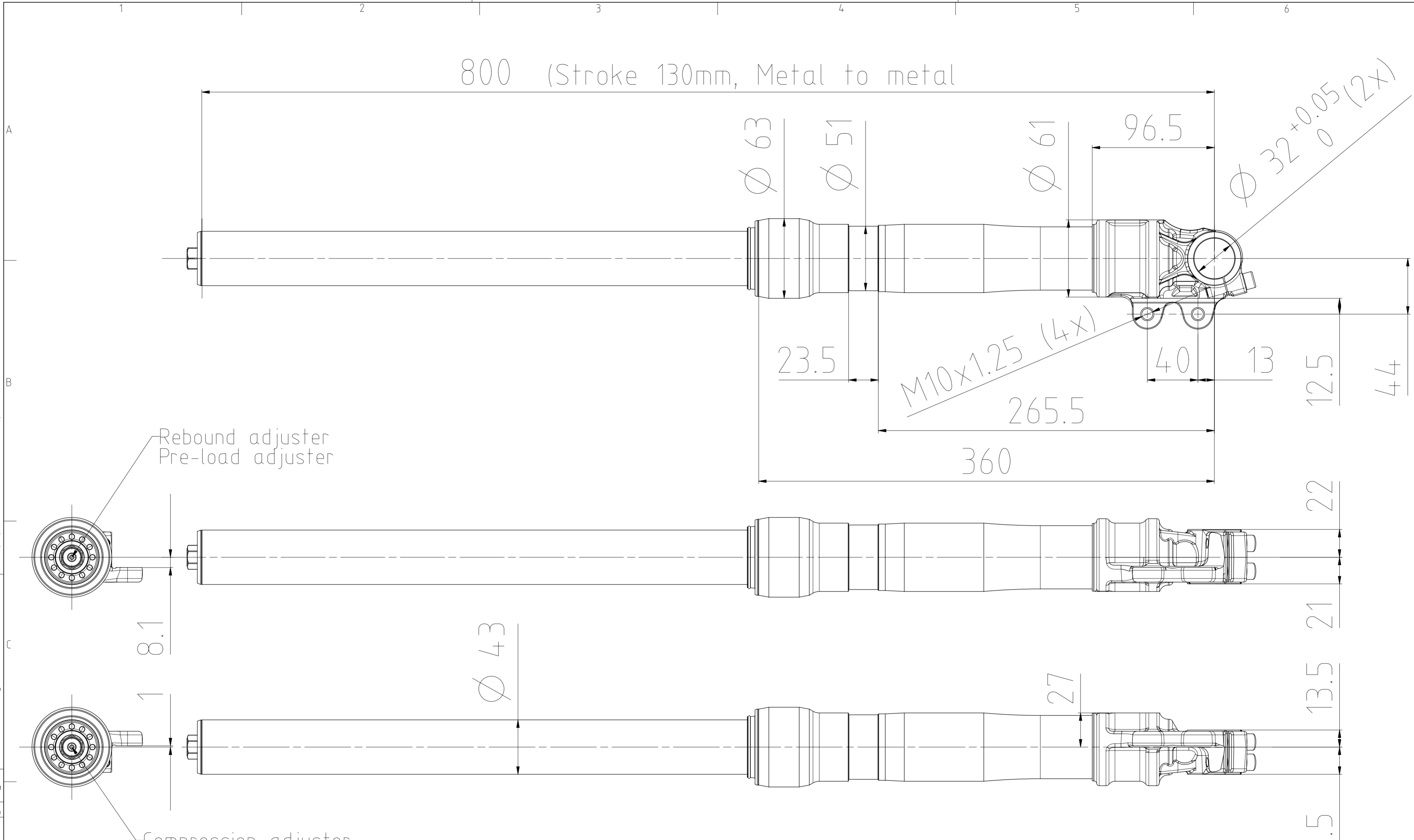
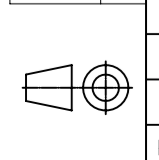

| Setup data | |
|-----------------|---------------|
| Compression | 15 clicks out |
| Rebound | 15 clicks out |
| Spring pre-load | 11 mm |
| Spring rate | 9.5 N/mm |
| Oil level | 210 mm |

| Rev. | Type of change | Sign. | Date | Rev.no |
|------|---------------------------------|-------|--------|--------|
| A | Drawing released for production | HELE | 161128 | |

| | | | | | |
|-----------------------|-------|----------------|----------------|-------------------|----------|
| Material | | Heat treatment | | Surface treatment | |
| Date | Drawn | Approved | Format | Scale | Compare |
| 2016-11-28 | HELE | TAN | A2 | 1:2 | |
| Designation (swedish) | | | Drawing number | | Revision |
| | | | FG_620 | | A |
| Designation (english) | | | | | |
| Retro 43 RWU Gold | | | | | |