

#### Kit Contents

Description	Part No	Pcs
Shock absorber	KA 464	1
Tie rap	00231-01	2
Screw M8x45	01046-49	1
Screw M6x12	05404-01	2
Sticker Öhlins	10207-01	1
Sticker Memo notes	01180-01	1
Owner's manual	07242-07	1

#### 👁 Note!

Please note that there can be small differences between your product and the images in these instructions.

#### 👁 Note!

Please note that during storage and transport, especially at high ambient temperature, some of the oil and grease used for assembly may leak and stain the packaging. This will not cause damage to the product, wipe off the excessive oil or grease with a cloth.

#### 👁 Note!

Before you install this product, check the kit contents. If anything is missing, please contact an Öhlins dealer.

#### ⚠ Warning!

Before you install this product, read the Öhlins Owner's manual. This product is an important part of the vehicle and the vehicle stability.

## Shock absorber for Kawasaki H2 SX

# KA 464

## Mounting Instructions

# MOUNTING INSTRUCTIONS

## **⚠ Warning!**

*We strongly recommend to let an Öhlins dealer install this product.*

## **⚠ Warning!**

*If you work with a lifted vehicle, make sure that it is safely supported to prevent it from tipping over.*

## **👁 Note!**

*When you work with this product, see the vehicle service manual for vehicle specific procedures and important data.*

## **👁 Note!**

*Before you install this product clean the vehicle.*

**1**

Put the bike on a stand so that the rear wheel is off the ground.

**2**

Loosen the original preload adjuster.

**3**

Loosen the pull rods at the triangle link.

## **👁 Note!**

*You may need to loosen the exhaust clamp to get the pull rod screw out.*

**4**

Loosen the lower end of the shock absorber.

**5**

Loosen the upper end of the shock absorber and remove it downwards.

## **👁 Note!**

*You may need to press the plastic cover above the screw upwards slightly to get the screw out.*

**6**

Mount the Öhlins unit in the opposite way. Lower the vehicle so that the suspension is slightly compressed and then tighten the screws.

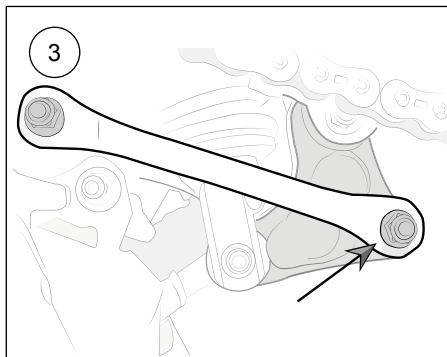

# MOUNTING INSTRUCTIONS

**7**

Mount the Öhlins preload adjuster at the silencer bracket. Use supplied screw M8x45.

**8**

Tie the hose using supplied ty-raps.

**9**

Fasten the brake fluid reservoir using supplied screws M6x12.

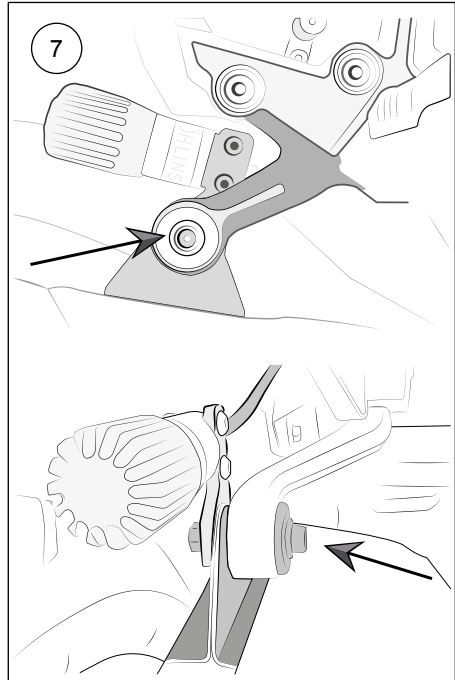

# ADJUSTMENTS

## **⚠ Warning!**

Before you ride/drive, always make sure that the setup is according to the recommended setup data. Read about adjustments and setting up in the Öhlins Owner's Manual before you make any adjustments. Contact an Öhlins dealer if you have any questions about setting up.

## SETUP DATA

Length	318 +6/0	mm
Stroke	57	mm
Rebound	14	clicks
Compression	14	clicks
Spring preload	12	mm
Spring	21040-44	
Spring rate	120	N/mm
Spring free length	160	mm
<b>Recommended free sag and ride height</b>		
R1-R3	50	mm
F1-F3	48	mm

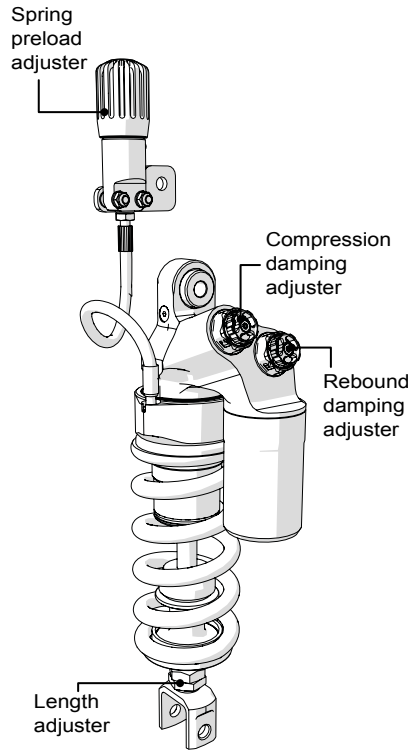

Öhlins products are subject to continuous improvement and development, therefore, although these instructions include the most up-to-date information available at the time of printing, minor updates may occur.

To find the latest information contact an Öhlins distributor. Please contact Öhlins if you have any questions regarding the contents in this document.

Part no. MI\_KA464\_0  
Issued 2018-08-13

© Öhlins Racing AB. All rights reserved. Any reprinting or unauthorized use without the written permission of Öhlins Racing AB is prohibited.

Öhlins Racing AB  
Box 722  
S-194 27 Upplands Väsby, Sweden  
Phone +46 8 590 025 00  
fax +46 8 590 025 80



[www.ohlins.com](http://www.ohlins.com)