

#### Kit Contents

Description	Part No	Pcs
Shock absorber	KA040	1
Wire harness	21770-03	1
Tie rap	00231-01	4
Tie rap	00231-05	5
Tie rap holder	21300-01	3
Sticker Mechatronic sys	00191-46	2
Sticker memo notes	01180-01	1
Owner's manual	07242-03	1

#### 👁 Note!

Please note that this image is a general representation of the product and may differ slightly from your product.

#### 👁 Note!

Please note that during storage and transportation, especially at high ambient temperature, some of the oil and grease used for assembling may leak and stain the packaging. This is in no way detrimental to the product, wipe off the excessive oil/grease with a cloth.

#### 👁 Note!

Before installing this product, check the contents of the kit. If anything is missing, please contact an Öhlins dealer.

#### ⚠ Warning!

Before installing this product, read the Öhlins Owner's Manual. The shock absorber/front fork/steering damper is an important part of your vehicle and will affect the stability.

## Shock absorber for Kawasaki ZX10R

# KA 040

## Mounting Instructions

# MOUNTING INSTRUCTIONS

## **⚠ Warning!**

*It is advisable to have an Öhlins dealer install the shock absorber/front fork/steering damper.*

## **⚠ Warning!**

*If working on a raised vehicle, ensure it is securely supported so that it will not tip.*

## **👁 Note!**

*Before mounting this product clean the vehicle thoroughly.*

## **👁 Note!**

*When working on this product, always see the Vehicle Service Manual for vehicle specific procedures and important data.*

**1**

Put the motorcycle on a workstand so that the rear wheel barely touches the ground.

**2**

Remove the seat and tank.

**3**

Remove the lower and the upper screws of the original shock absorber.

**4**

Remove the original shock absorber from the top of the vehicle.

**5**

Install the Öhlins shock absorber. First, fasten the upper screw, then the lower. Use the original screws, do not tighten yet.

## **👁 Note!**

*Lower the vehicle so that the suspension is slightly compressed before tightening the screws.*

**6**

Tighten the upper and the lower screws.

**7**

Install the hydraulic preload adjuster at the silencer mounting point. Use the original screws and nut. Fasten the hose with the tie raps provided in this kit.

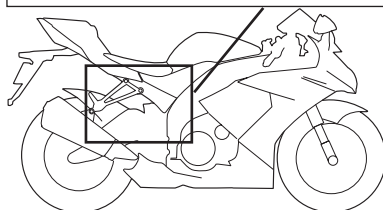
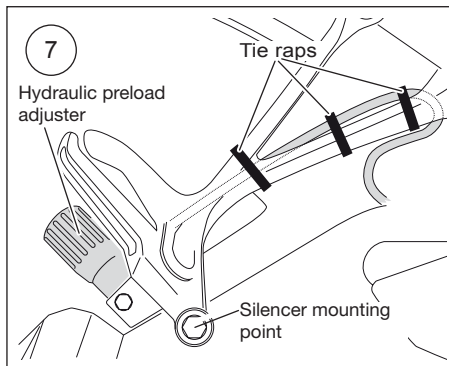

**8**

Disconnect the negative terminal of the battery.

**9**

Locate the small ECU at the front right side of the fuel tank, behind the plastic tank panel.

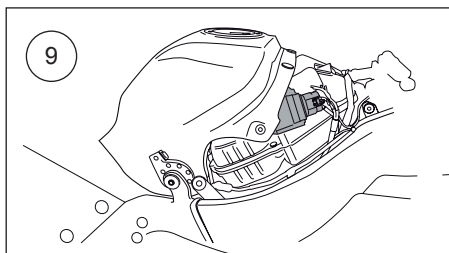

**10**

Disconnect the wire harness from the ECU.

**11**

Remove the orange front cap. Press the two petals to the sides, and at the same time, pull the orange front cap forward. See image.

**12**

Use a Ø1-1,5mm object to push the 8 dummy pins out. Push from the front. See image.

# MOUNTING INSTRUCTIONS

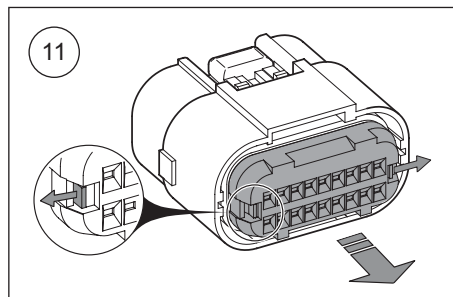

## ⚠ Warning!

Read before beginning with step 13; If you push the wrong wire harness pins into wrong position they will be very difficult to remove. Make sure you push the wire harness pins into the correct positions, see image below.

## 13

The 8 pins on the wire harness provided in the kit shall be pushed into the connector according to the image;

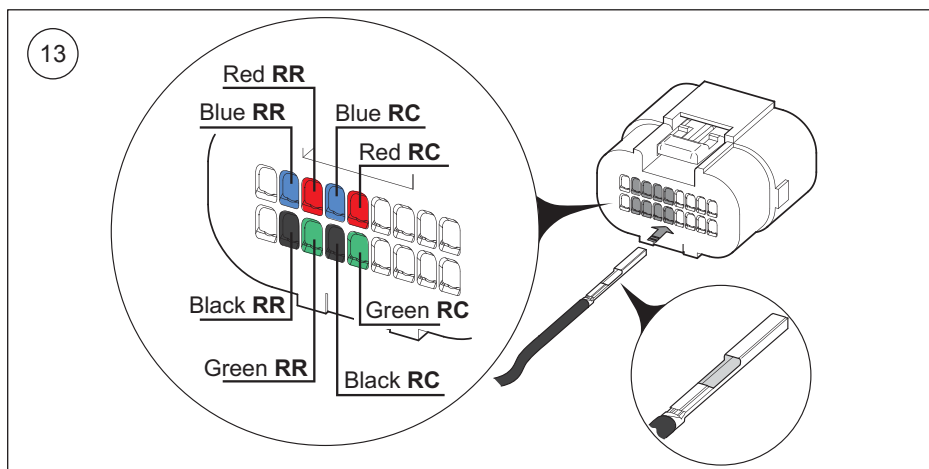
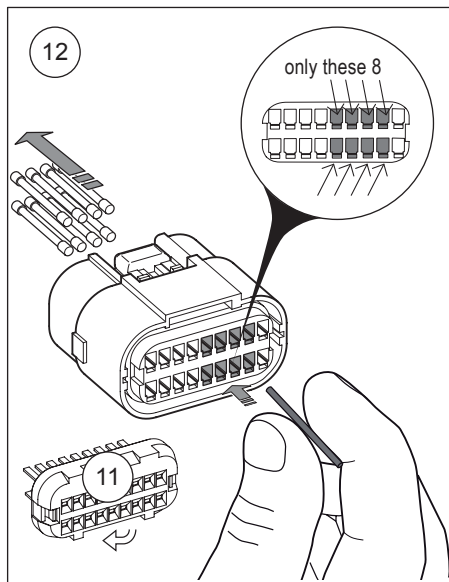

## 👁 Note!

The pins shall be oriented with the open side up. Push into the connector until a noticeable click and stop.

## 14

Reinstall the orange front cap.

## 15

Connect the wire harness to the ECU.

## 16

Route the cables from the wire harness towards the rear on the right side. Route the cables to the left side behind the air box. Lead the cables towards the rear on the left side, inside the frame, above the upper mounting point of the rear subframe.

17

Connect the wires from the ECU to the shock absorber;  
Connect wires marked RC to C  
Connect wires marked RR to R

18

Fasten the wire harness with the tie raps and tie rap holders provided in this kit.

19

Connect the battery cable.

20

Reinstall the tank and seat.

## ADJUSTMENTS

### ⚠ Warning!

*Before riding, always make sure that the basic settings made by Öhlins are according to recommended Set-up Data. Read about adjustments and setting up in the Öhlins Owner's Manual before you make any adjustments. Contact an Öhlins dealer if you have any questions about setting up.*

## SET-UP DATA

Length	309 <sup>+6</sup> / <sub>0</sub>	mm	Free sag R1-R2	20	mm
Stroke	59	mm	Ride height R1-R3	32	mm
Spring preload	15	mm	Free sag F1-F2	30	mm
Spring	21040-39		Ride height F1-F3	40	mm
	110	N/mm			
Free spring length	160 <sup>0</sup> / <sub>3</sub>	mm			

👁 Öhlins products are subject to continuous improvement and development, therefore, although these instructions include the most up-to-date information available at the time of printing, minor updates may occur.

To find the latest information contact an Öhlins distributor. Please contact Öhlins if you have any questions regarding the contents in this document.

Part no. MI\_KA040\_2  
Issued 2013-06-19

© Öhlins Racing AB. All rights reserved. Any reprinting or unauthorized use without the written permission of Öhlins Racing AB is prohibited.

Öhlins Racing AB  
Box 722  
S-194 27 Upplands Väsby, Sweden  
Phone +46 8 590 025 00  
fax +46 8 590 025 80

### 👉 Caution!

*Ensure to bend the hydraulic preload adjuster hose away from the swing arm.*

### 👉 Caution!

*Ensure that nothing interferes with the hose or the adjuster when the rear wheel suspension is fully extended/compressed.*

### 👉 Caution!

*Ensure that all screws are tightened to the correct torque and that nothing fouls or restricts movement of the shock absorber/front fork/steering damper when the suspension is fully compressed or extended.*

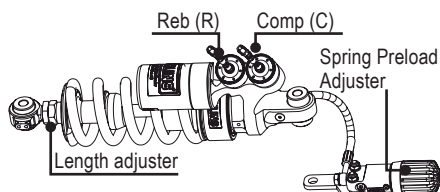

The damping in this EC-Shock absorber is continuously adjusted according to the riding style. Depending on which power mode (Full, Medium, Low) that is selected on the handle bar, the damping is biased towards comfort on "Low" and towards traction and handling on "Full".



[www.ohlins.com](http://www.ohlins.com)