



| Kit Contents | | | |
|--------------|-----------------------------|----------|-----|
| | Description | Part No | Pcs |
| 1.1 | Shock absorber front, left | TES 1X00 | 1 |
| 1.2 | Shock absorber front, right | TES 2X00 | 1 |
| 2 | Dust boot | 10216-02 | 2 |
| 3 | Plastic spacer | 25602-01 | 4 |
| 4 | Spring | 49250-19 | 2 |
| 5 | Upper spring seat | 25618-37 | 2 |
| 6 | Top pin spacer | 24629-60 | 2 |
| 7 | Flange lock nut M10 | 24626-01 | 2 |
| 8 | Adjustment knob | 24631-04 | 2 |
| 9 | Wire adjuster | 24631-03 | 2 |
| 10 | Wire 65 mm | 24632-04 | 2 |
| 11 | Adjustment wheel | 24633-01 | 2 |
| 12 | Adjustment wheel screw | 24633-02 | 2 |
| 13 | C-spanner | 24639-01 | 1 |
| 14 | C-spanner | 24639-03 | 1 |
| 15 | Öhlins sticker kit | 10207-01 | 1 |
| 16 | Öhlins owner manual | | 1 |

Note!

Please note that there can be small differences between your product and the images in these instructions.

Note!

Please note that during storage and transport, especially at high ambient temperature, some of the oil and grease used for assembly may leak and stain the packaging. This will not cause damage to the product, wipe off the excessive oil or grease with a cloth.

Note!

Before you install this product, check the kit contents. If anything is missing, please contact an Öhlins dealer.

Warning!

Before you install this product, read the Öhlins Owner's manual. This product is an important part of the vehicle and the vehicle stability.

Note!

If the vehicle is equipped with OE electronic shock absorbers, use Öhlins cancellation kit. See products news for part number.

Shock Absorber Kit for Tesla Model 3 & Model Y

TES MX00S1 front

Mounting Instructions



MOUNTING INSTRUCTIONS

⚠ Warning!

We strongly recommend to let an Öhlins dealer install this product.

⚠ Warning!

If you work with a lifted vehicle, make sure that it is safely supported to prevent it from tipping over.

👁 Note!

When you work with this product, see the vehicle service manual for vehicle specific procedures and important data.

👁 Note!

Before you install this product clean the vehicle.

1

Raise the vehicle and put it on jack stands.

2

Remove the front wheels.

3

Loosen the bolt for the lower shock absorber attachment and the nut for anti roll bar link.

👁 Note!

Support the wheel hubs in an appropriate way on each side of the vehicle so that the brake hoses can not be damaged.

4

Loosen the upper control arm and upper attachments for the shock absorber and remove the shock absorber from the vehicle.

5

Install the dust boot (2), the plastic spacer (3), the spring (4), the plastic spacer (3), the upper spring seat (5), the top pin spacer (6), the OE top mount and the M10 lock nut (7) according to fig 1. Tighten the lock nut to 25 Nm and install the adjustment knob (8) for Model Y or the wire adjuster (9), wire 65 mm (10) for model 3. Tighten the adjuster to 10 Nm.

👁 Note!

Due to the large amount of preload on the spring, use a spring compressor when assembling the front spring.

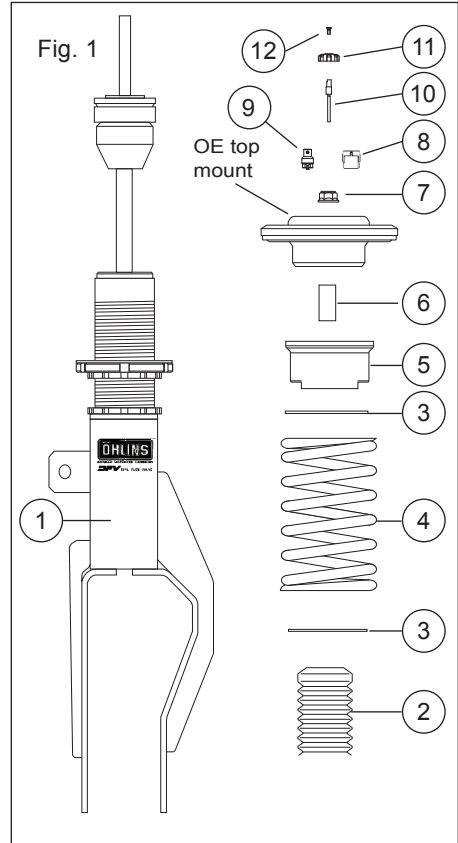

👁 Note!

When tightening the top mount nut, the shock absorber shaft must be held in position with an Allen key.

MOUNTING INSTRUCTIONS

6

Position the lower spring seat and the lower fork bracket according to fig 3 and tighten with the c-spanner.

7

Fasten the upper attachments to the vehicle body.

8

Raise the wheel hub with a jack to remove the freeplay of the lower bracket attachment and tighten the bolt to OE spec.

Note!

Make sure that all bolts are tightened to the correct torque and that nothing fouls or restricts movement of the strut when it is being fully compressed or extended. Test this over the whole steering range from lock to lock.

Only for Tesla Model 3

Drill a 9 mm hole in the front trunk plastic above the shock absorber top mount for the wire adjuster according to fig 2. Tighten the adjustment wheel (11) with the adjustment wheel screw (12).

Only for Tesla Model Y

To be able to reach the adjuster when adjusting the front shock absorbers with the adjustment knob, the front trunk plastic needs to be removed along with the windshield washer reservoir tube on the left side.

9

Make sure that all removed parts are reinstalled in the same way as they were before the installation of the Öhlins shock absorber.

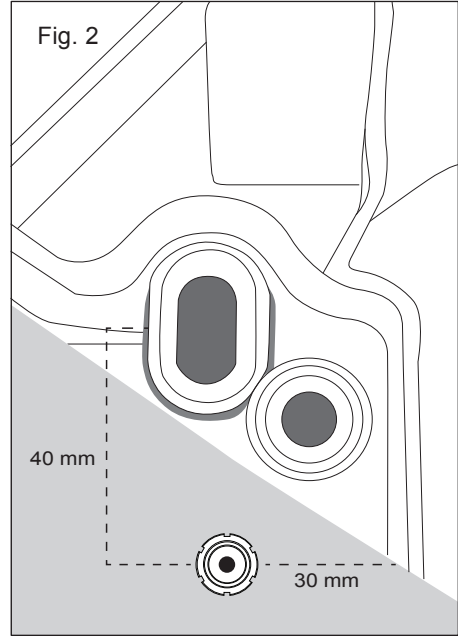

ADJUSTMENTS

⚠ Warning!

Before you drive, always make sure that the setup is according to the recommended setup data. Read about adjustments and setting up in the Öhlins Owner's Manual before you make any adjustments. Contact an Öhlins dealer if you have any questions about setting up.

SETUP DATA

| | | |
|----------------------------|-------|--------|
| Rebound setting | | |
| Winding road | 5-10 | clicks |
| Street | 10-20 | clicks |
| Model 3 spring preload (X) | 215 | mm |
| Model Y spring preload (X) | 205 | mm |

Recommended spring

49250-19 (70 N/mm)

The actual vehicle height

With the preload and length adjuster in their recommended position, the vehicle is lowered approximately -10 mm when compared to the original suspension. Depending on car model and equipment, the height may vary. Tesla with Performance package is lowered 10 mm from factory and will therefore be lowered 10mm less. Adjust the height adjuster until you have reached your desired ride height.

Fig. 3

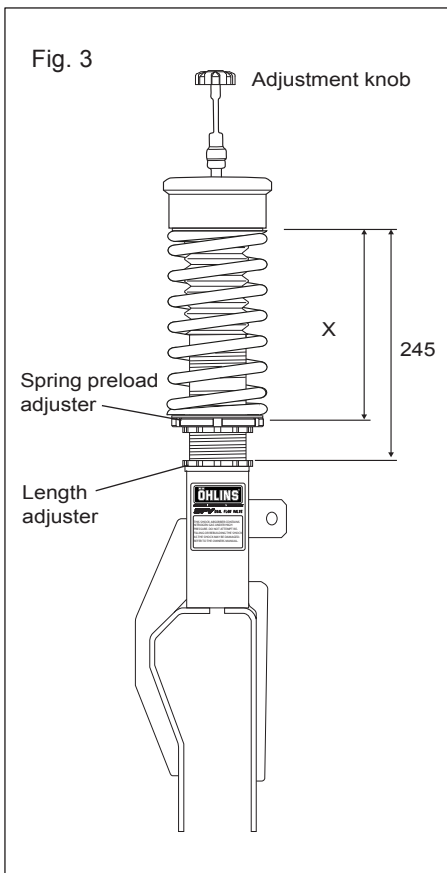

⚠ Warning!

The spring preload adjuster position adjustment range is 0-45 mm, do not preload the spring more or it will coilbind. Make sure the spring is always preloaded.

Öhlins products are subject to continuous improvement and development, therefore, although these instructions include the most up-to-date information available at the time of printing, minor updates may occur.

To find the latest information contact an Öhlins distributor. Please contact Öhlins if you have any questions regarding the contents in this document.

Part no. ML_TES MX00S1_0
Issued 2023-08-29

© Öhlins Racing AB. All rights reserved. Any reprinting or unauthorized use without the written permission of Öhlins Racing AB is prohibited.

Öhlins Racing AB
Box 722
S-194 27 Upplands Väsby, Sweden
Phone +46 8 590 025 00
fax +46 8 590 025 80



www.ohlins.com



| Kit Contents | | | |
|--------------|-------------------------|----------|-----|
| Pos nr | Description | Part No | Pcs |
| 1 | Shock absorber rear | TES 6X00 | 2 |
| 2 | End eye spacer | 24629-61 | 4 |
| 3 | Dust boot | 10216-03 | 2 |
| 4 | Tie-rap | 24616-01 | 4 |
| 5 | Flange lock nut M10 | 24626-01 | 2 |
| 6 | Spring preload adjuster | 24651-13 | 2 |
| 7 | Lock nut M52 | 24636-03 | 2 |
| 8 | Spring platform | 24635-03 | 2 |
| 9 | Plastic spacer | 25602-01 | 2 |
| 10 | Spring | 47040-22 | 2 |

Note!

Please note that there can be small differences between your product and the images in these instructions.

Note!

Please note that during storage and transport, especially at high ambient temperature, some of the oil and grease used for assembly may leak and stain the packaging. This will not cause damage to the product, wipe off the excessive oil or grease with a cloth.

Note!

If the vehicle is equipped with OE electronic shock absorbers, use Öhlins cancellation kit. See product news for part number.

Note!

Before you install this product, check the kit contents. If anything is missing, please contact an Öhlins dealer.

Warning!

Before you install this product, read the Öhlins Owner's manual. This product is an important part of the vehicle and the vehicle stability.

Shock Absorber Kit for Tesla Model 3 & Model Y

TES MX00S1 rear

Mounting Instructions

MOUNTING INSTRUCTIONS

⚠ Warning!

We strongly recommend to let an Öhlins dealer install this product.

⚠ Warning!

If you work with a lifted vehicle, make sure that it is safely supported to prevent it from tipping over.

👁 Note!

When you work with this product, see the vehicle service manual for vehicle specific procedures and important data.

👁 Note!

Before you install this product clean the vehicle.

1

Raise the vehicle and put it on jack stands.

2

Remove the rear wheels.

3

Remove the lower and the upper attachments and remove the original shock absorbers.

4

Remove the spring.

5

Mount the lock nut (7), spring platform (8) plastic spacer (9) on the spring preload adjuster (6) according to fig 2. Adjust the spring platform on the spring preload adjuster according to fig 3. Tighten the lock ring with the c-spanners.

6

Install the spring preload adjuster assembly on the control arm, the spring (10), use the OE rubber spring seat between the body and spring according to fig 2.

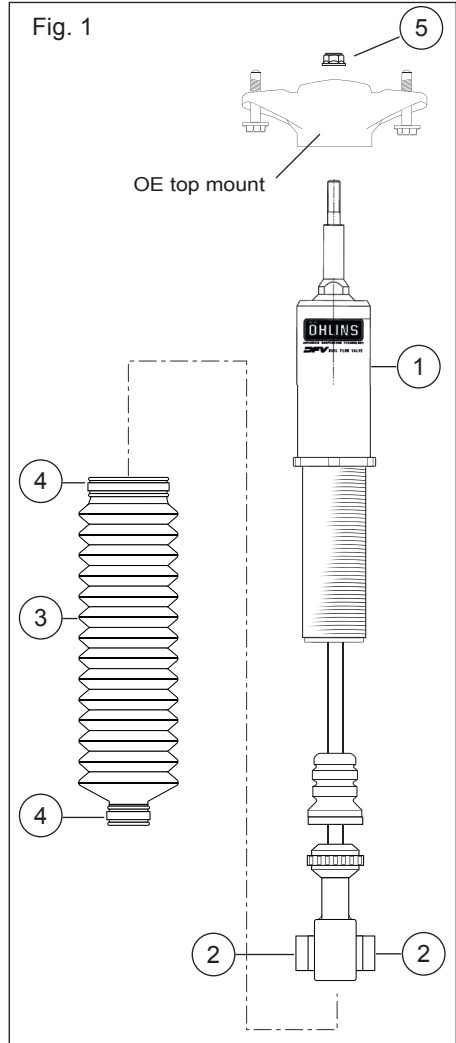

MOUNTING INSTRUCTIONS

7

Mount the dust boot (3) with the zip-ties (4) on the Öhlins shock absorber (1) according to fig 1 and install the OE top mount with the flange lock nut M10 (5) Tighten the nut to 35Nm.

8

Install the Öhlins shock absorbers on the vehicle and tighten the top mount bolts and lower bolt to OE spec.

👁 **Note!**

Make sure that all bolts are tightened to the correct torque and that nothing fouls or restricts movement of the shock absorber when it is being fully compressed or extended.

9

Make sure that all removed parts are reinstalled in the same way as they were before the installation of the Öhlins shock absorber.

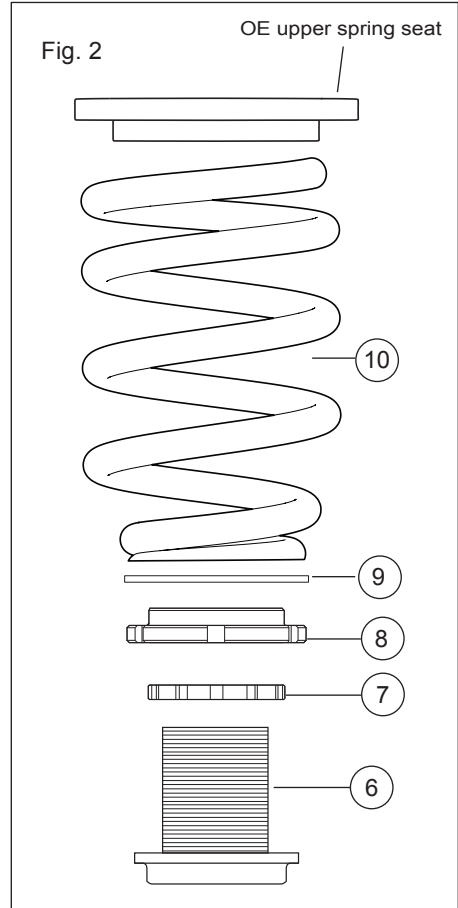

ADJUSTMENTS

⚠ Warning!

Before you ride/drive, always make sure that the setup is according to the recommended setup data. Read about adjustments and setting up in the Öhlins Owner's Manual before you make any adjustments. Contact an Öhlins dealer if you have any questions about setting up.

SETUP DATA

| | | |
|--------------------------------------------|-------|--------|
| Rebound setting | | |
| Winding road | 5-10 | clicks |
| Street | 10-20 | clicks |
| Model 3 spring preload adjuster height (X) | 18 | mm |
| Model Y spring preload adjuster height (X) | 20 | mm |

Recommended spring

47040-22 (80 N/mm)

The actual vehicle height

With the spring preload adjuster in their recommended position, the vehicle is lowered approximately -10 mm when compared to the original suspension. Depending on car model and equipment, the height may vary. Tesla with Performance package is lowered 10 mm from factory and will therefore be lowered 10 mm less. Adjust the spring preload until you have reached your desired height. Make sure that the spring is always preloaded.

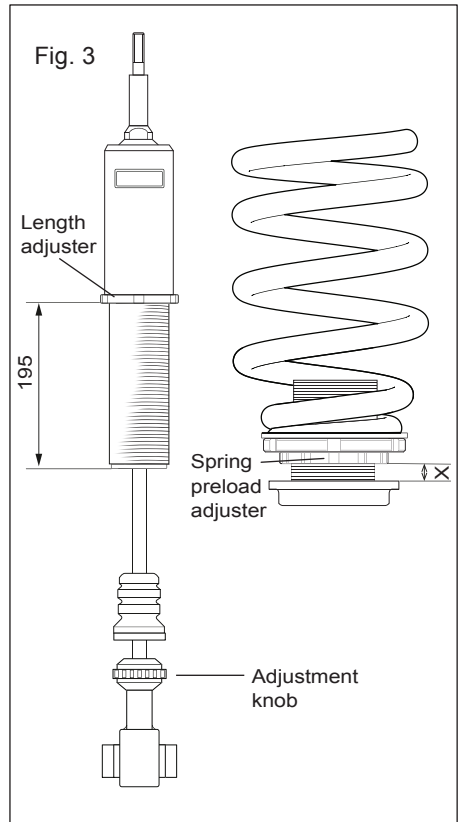

Öhlins products are subject to continuous improvement and development, therefore, although these instructions include the most up-to-date information available at the time of printing, minor updates may occur.

To find the latest information contact an Öhlins distributor. Please contact Öhlins if you have any questions regarding the contents in this document.

Part no. ML_TES MX00S1_0
Issued 2023-08-29

© Öhlins Racing AB. All rights reserved. Any reprinting or unauthorized use without the written permission of Öhlins Racing AB is prohibited.

Öhlins Racing AB
Box 722
S-194 27 Upplands Väsby, Sweden
Phone +46 8 590 025 00
fax +46 8 590 025 80



www.ohlins.com