

Adjustments

⚠ Warning!

Before riding, always make sure that the basic settings made by Öhlins are according to recommended Set-up Data. Read about adjustments and setting up in the Öhlins Owner's Manual before you make any adjustments. Contact an Öhlins dealer if you have any questions about setting up the shock absorber.

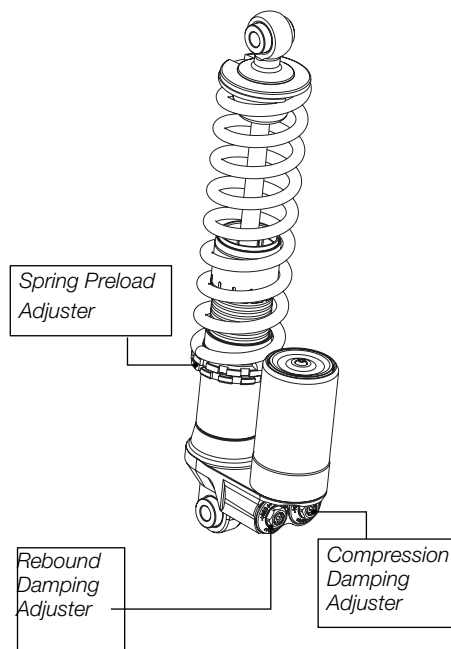

Set-up Data

Recommended Set-up

Spring preload	2 turns (3 mm)
Rebound damping	12 clicks
Compression damping	12 clicks

Shock absorber data

Length	276 mm
Stroke	76 mm

Free sag and Ride height

Free sag, rear	20±5 mm
----------------	---------

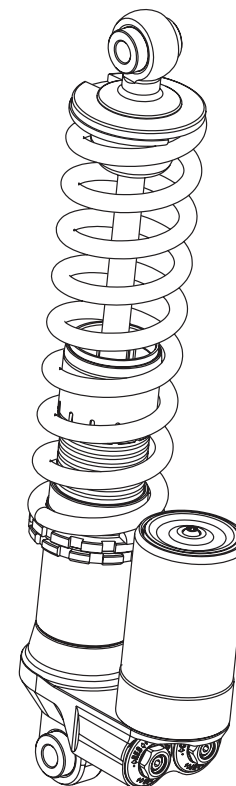

Before installing this product, check the contents of the kit. If anything is missing, please contact your nearest Öhlins dealer.

Kit Contents

	Part No.	Pcs.
Shock absorber	KT 1397	1
Spring clip	00116-03	1
C-spanner	00710-01	1
Öhlins Sticker set	10207-01	1
Owner's Manual	07251-02	1

👁 Note!

No spring included in this kit. See the Spring Guide in this folder or contact an Öhlins dealer for advise.

Please note that during storage and transportation, especially at high ambient temperature, some of the oil and grease used for assembling may leak and stain the packaging. This is in no way detrimental to the product, wipe off the excessive oil/grease with a cloth.

⚠ Warning!

Before installing this product, read the Öhlins Owner's Manual. The shock absorber is an important part of your vehicle and will affect the stability.

👁 Öhlins products are subject to continuous improvement and development, therefore, although these instructions include the most up-to-date information available at the time of printing, minor updates may occur.

To find the latest information contact your Öhlins distributor. Please consult your Öhlins dealer if you have any questions regarding the contents in this document.

Part no. KT1397_0
Issued 2012-09-25



© Öhlins Racing AB. All rights reserved. Any reprinting or unauthorized use without the written permission of Öhlins Racing AB is prohibited.

Öhlins Racing AB
Box 722
S-194 27 Upplands Väsby, Sweden
Phone +46 8 590 025 00
fax +46 8 590 025 80



www.ohlins.com

Shock Absorber for KTM 50 SX **KT 1397**

Mounting Instructions



Spring recommendation list.

SX 50		
Riders weight	Spring rate	Spring
kg/pounds	N/mm	part.no
<25/55	30	00281-02
<35/77	36	00281-32
<45/77	40	00281-34

Rider's weight: Rider wearing all riding equipment

⚠ Warning!

It is advisable to have an Öhlins dealer install the shock absorber.

When installing, consult your Vehicle Service Manual.

1

Measure the free length of the spring (A).

2

Install the spring clip, turn the shock absorber so that the spring rests against the spring platform and turn the rings (lock nut and spring platform) so they touch the upper surface of the spring.

3

Set the spring preload;

Use a C-spanner. Turn the upper spring platform approximately 2 turns (3 mm) clockwise to preload the spring before installing the shock absorber to the vehicle.

Change the Spring

1

To remove the original spring, you must first release the spring preload by turning the upper spring platform counter clockwise. Use a C-spanner.

2

Remove the spring clip and then the original spring.

3

Change spring and set the new spring preload according to the section above.

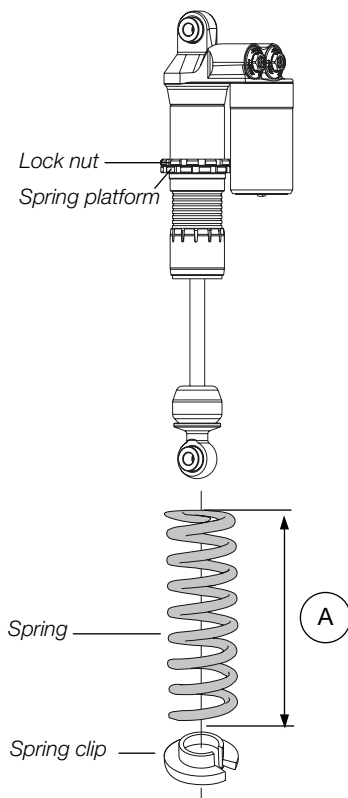

A - B = Spring Preload

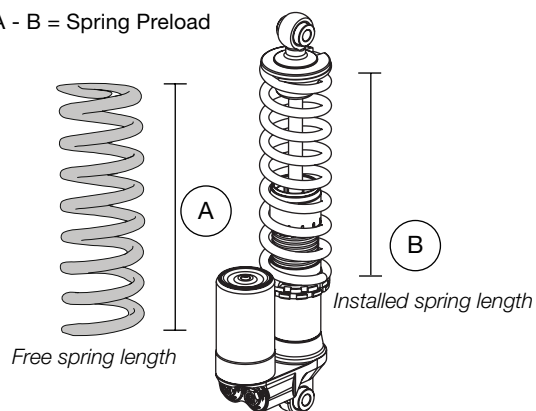

⚠ Warning!

It is advisable to have an Öhlins dealer install the shock absorber.

When installing, consult your Vehicle Service Manual.

1

Put the motorcycle on a workstand so that the rear wheel barely touches the ground.

⚠ Warning!

Make sure the vehicle is securely supported so that it will not tip.

2

Loosen the lower and the upper attachment of the original shock absorber. Remove it from the motorcycle.

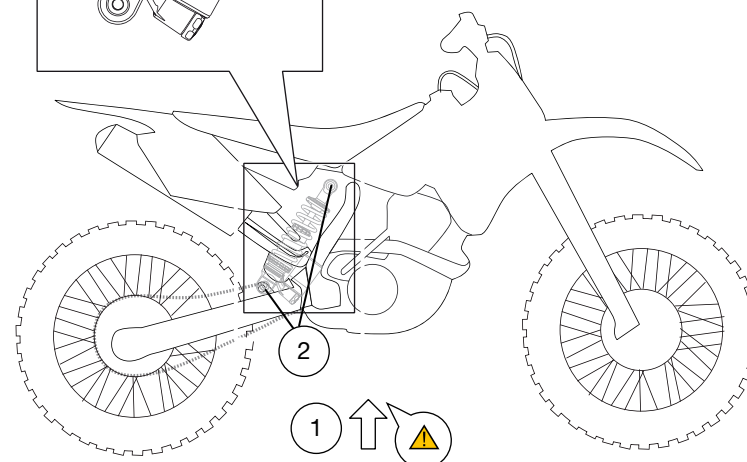
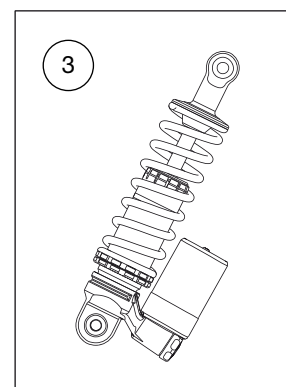

👁 Note!

Before installing the Öhlins shock absorber clean the vehicle thoroughly.

3

Install the Öhlins shock absorber with the reservoir upside down, pointing towards the front, see figure.

👁 Note!

Lower the motorcycle so that the shock absorber is slightly compressed, before tightening the screws.

4

Tighten the upper and the lower attachments. Make sure that all removed parts are installed in the same way as they were before the installation.

⚠ Warning!

Make sure that all screws are tightened to the correct torque and that nothing fouls or restricts movement of the shock absorber when the suspension is fully compressed or extended.

VEHICLE
SERVICE
MANUAL